

Symbol

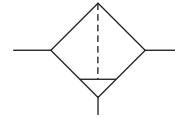

Ordering code

AF	2000	02	D
Model	Series code	Port size	Drain method
AF A Series Filter	1000 1000 Series 2000 2000 Series 3000 3000 Series 4000 4000 Series 5000 5000 Series	M5 M5 02 1/4" 03 3/8" 04 1/2" 06 3/4" 10 1"	Blank Manual drain A Semi-auto drain D Automatic drain

Specification

Model	Manual drain	AF1000-M5	AF2000-02	AF3000-02	AF3000-03	AF4000-03	AF4000-04	AF4000-06	AF5000-06	AF5000-10
	Automatic drain	AF1000-M5D	AF2000-02D	AF3000-02D	AF3000-03D	AF4000-03D	AF4000-04D	AF4000-06D	AF5000-06D	AF5000-10D
Port size		M5×8	1/4	1/4	3/8	3/8	1/2	3/4	3/4	1
Cup capacity		4	15	20	20	45	45	45	130	130
Rated flow(L/min)		110	750	1500	1500	4000	4000	6000	7000	7000
Proof pressure		1.5MPa{15.3kgf/cm ² }								
Max. pressure		1.0MPa{10.2kgf/cm ² }								
Temperature range		5~60℃								
Filtering grade		5μm								
Cup material		Polycarbonate								
Cup protective cover		AF1000~2000(Without)				AF3000~5000(With)				
Assembly	Manual drain	C100F	C200F	C300F	C300F	C400F	C400F	C400F	C400F	C400F
	Automatic drain	AD61	AD62	AD43	AD43	AD44	AD44	AD44	AD44	AD44
Weight(kg)		0.07	0.19	0.29	0.29	0.55	0.55	0.58	1.08	1.08

Note: 1. there are 2, 10, 20, 40, 70, 100μm to choose from.

2. Standard automatic drainage for normally open(N.O.), AF3000~5000 also has normally closed(N.C.)to choose from, and the lowest use pressure: normally open -0.1MPa(1kgf/cm²), normally closed -0.15MPa(1.5kgf/cm²).

3. Supply pressure is 0.7MPa(7.1kgf/cm²)case.

Main parts

No.	Name	Material			Note
		AF1000~2000	AF3000~4000\4000-06	AF5000	
1	Filter body	Zinc die casting	Aluminum die casting	Aluminum die casting	Platinum plating silvery
9	base			Aluminum die casting	Platinum plating silvery

Parts list

No.	Parts name	Material	Parts No.					
			AF1000	AF2000	AF3000	AF4000	AF4000-06	AF5000
2	Filter element	Resin						
		Copper						
3	Separator	ABS						
4	O type seal ring	NBR						
5	Cup assembly	Polycarbonate						
6	Deflector	ABS						
7	O type seal ring	NBR						
8	Washer	NBR						

Inner structure

AF1000-2000

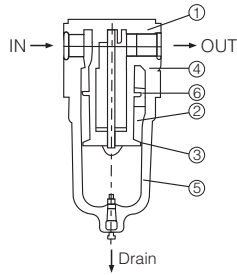

AF3000-4000

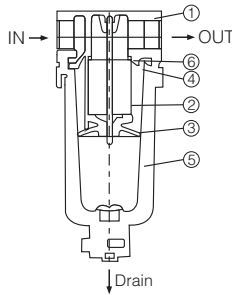

AF5000

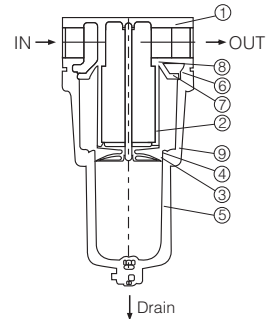

Dimensions

AF1000-2000

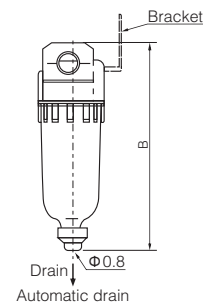
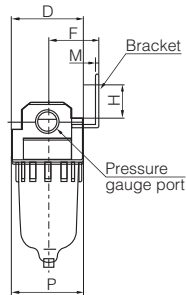
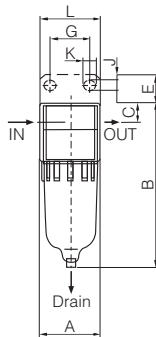

AF3000-4000

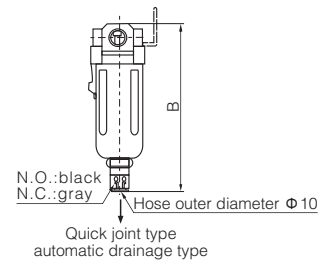
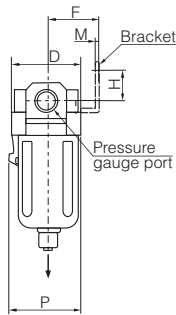
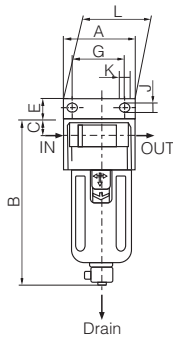

AF5000

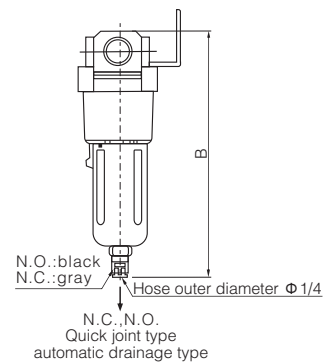
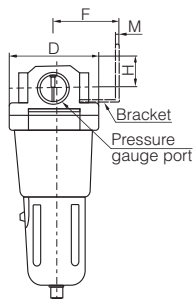
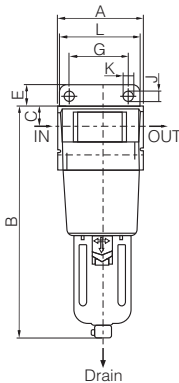

Model	Port size	A	B	C	D	E	F	G	H	J	K	L	M	P	B(Automatic drain)
Af1000	M5×0.8	25	66	7	25	-	-	-	-	-	-	-	-	26.5	86.5
AF2000	1/4	40	97.5	11	40	17	30	27	22	5.4	8.4	40	2.3	40	120.5
AF3000	1/4-3/8	53	132.5	14	53	16	41	40	23	6.5	8	53	2.3	56	170
AF4000	3/8-1/2	70	168.5	18	70	17	50	54	26	8.5	10.5	70	2.3	73	206
AF4000-06	3/4	75	172.5	20	70	14	50	54	25	8.5	10.5	70	2.3	73	210
AF5000	3/4-1	90	247.5	24	90	23	70	66	35	11	13	90	3.2	90	285.5